

# Gate valves – welded bonnet

Type

GA1500RBW

**Design construction:**

API 602 - BS 5352 - NF M87.412  
 Testing according to API 598 - BS 6755  
 Marking MSS SP25

Socket weld Ends to ANSI B16.11  
 Screwed Ends (NPT) to ANSI B1.20.1  
 Butt welding Ends to ANSI B.16.25

Outside Screw and Yoke (OS&Y)  
 Self aligning packing gland in two parts  
 Integral backseat  
 Body Bonnet weld to ASME IX

**Ratings:**

- carbon steel class 1500 - 3705 psig@100° F  
 255 bar + 38 °C

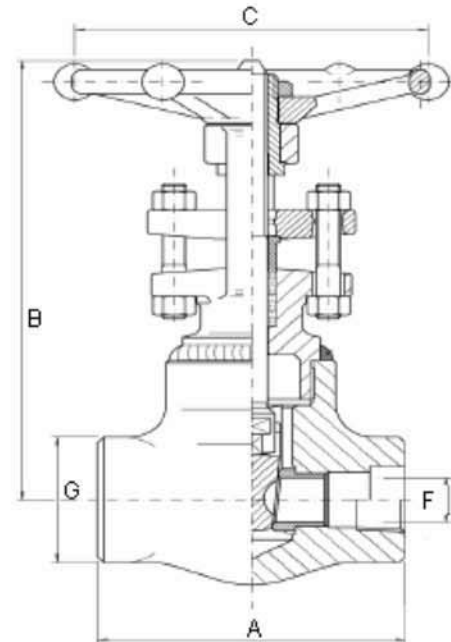

REDUCED BORE - TYPE 9WL 100		CLASS 1500				
size	inch	1/2	3/4	1	1.1/2	2
	mm	15	20	25	40	50
<b>A</b>		90	110	127	127	210
<b>B open</b>		153	190	220	282	345
<b>C</b>		88	97	138	138	138
<b>F</b>		9,6	14	18	30	36,6
<b>G</b>		38	48	56	78	85
<b>WEIGHT Kg</b>		2	3,3	5,3	9,8	18,3
<b>FIGURE</b>		9WL 103	9WL 104	9WL 105	9WL 107	9WL 108
<b>PACKING</b>		BH3	BH5	BH6/A	2B5	BH8

For special execution see special features  
 For materials and testing pressure see technical data

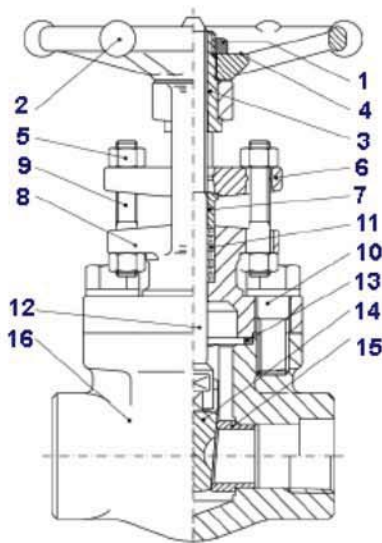

TYPICAL GATE		
PART	NAME	MATERIALS
1	HAND/WHEEL NUT	CARBON STEEL
2	HAND/WHEEL	CARBON STEEL
3	YOKE SLEEVE	AISI 416
4	NAME PLATE	ALUMINUM
5	GLAND NUTS	ASTM A194-2H
6	GLAND FLANGE	ASTM A105
7	PACKING GLAND	AISI316
8	BONNET	ASTM A105N
9	GLAND STUDS	ASTM A193 B6
10	B/B BOLTS	ASTM A193 B7
11	PACKING GLAND	GRAPHITE
12	STEM	ASTM A479 410
13	B/B GASKET	F316L+GRAPHITE
14	WEDGE	ASTM A182 F6a
15	SEAT RINGS	ASTM A479 410
16	BODY	ASTM A105 N