

Gate valves – welded bonnet

Type

GA800FBW

Design construction:

API 602 - BS 5352 - NF M87.412
 Testing according to API 598 - BS 6755
 Marking MSS SP25

Socket weld Ends to ANSI B16.11
 Screwed Ends (NPT) to ANSI B1.20.1
 Butt welding Ends to ANSI B.16.25

Outside Screw and Yoke (OS&Y)
 Self aligning packing gland in two parts
 Integral backseat
 Body Bonnet weld to ASME IX

Ratings:

- carbon steel class 800 - 1975 psig@100°F
 138 bar + 38°C

FULL BORE - Type W 100			CLASS 800						
size	inch	1/4	3/8	1/2	3/4	1	1.1/4	1.1/2	2
	mm	6	10	15	20	25	32	40	50
A		80	80	90	110	127	127	127	210
B open		152	152	158	196	225	255	290	358
C		88	88	88	97	138	138	138	172
F		8	9,6	14	18	24	30	36,6	48
G		32	32	38	48	56	64	78	85
WEIGHT Kg		1,5	1,5	2	3,5	5	6,5	9,5	16
FIGURE		W101	W102	W103	W104	W105	W106	W107	W108
PACKING		BH2	BH2	BH2	BH4	BH5	BH6/A	BY5/A	BH8

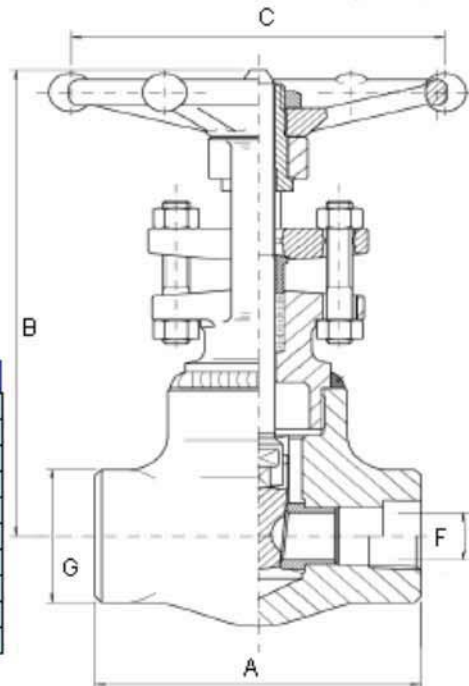

For special execution see special features
 For materials and testing pressure see technical data

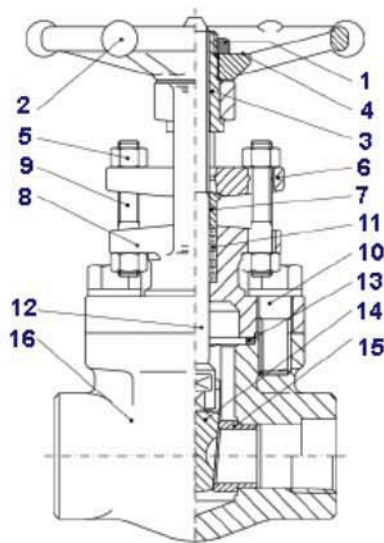

TYPICAL GATE		
PART	NAME	MATERIALS
1	HAND/WHEEL NUT	CARBON STEEL
2	HAND/WHEEL	CARBON STEEL
3	YOKE SLEEVE	AISI 416
4	NAME PLATE	ALUMINUM
5	GLAND NUTS	ASTM A194-2H
6	GLAND FLANGE	ASTM A105
7	PACKING GLAND	AISI316
8	BONNET	ASTM A105N
9	GLAND STUDS	ASTM A193 B6
10	B/B BOLTS	ASTM A193 B7
11	PACKING GLAND	GRAPHITE
12	STEM	ASTM A479 410
13	B/B GASKET	F316L+GRAPHITE
14	WEDGE	ASTM A182 F6a
15	SEAT RINGS	ASTM A479 410
16	BODY	ASTM A105 N